

By virtue of this seal and signature, all supporting documents included in this package are accurate and support the design presented herein.

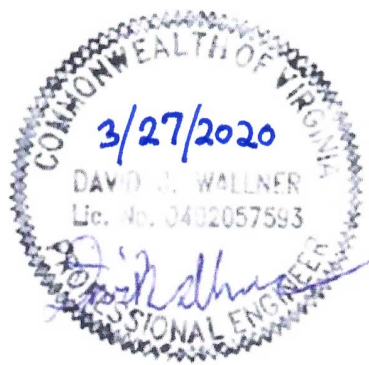

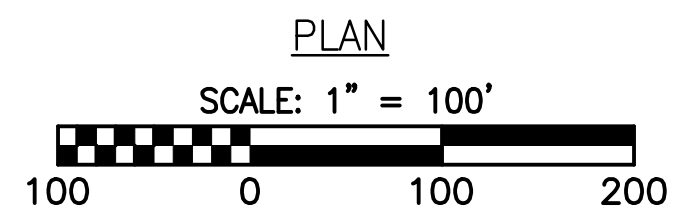
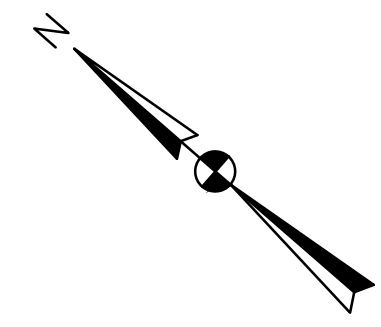
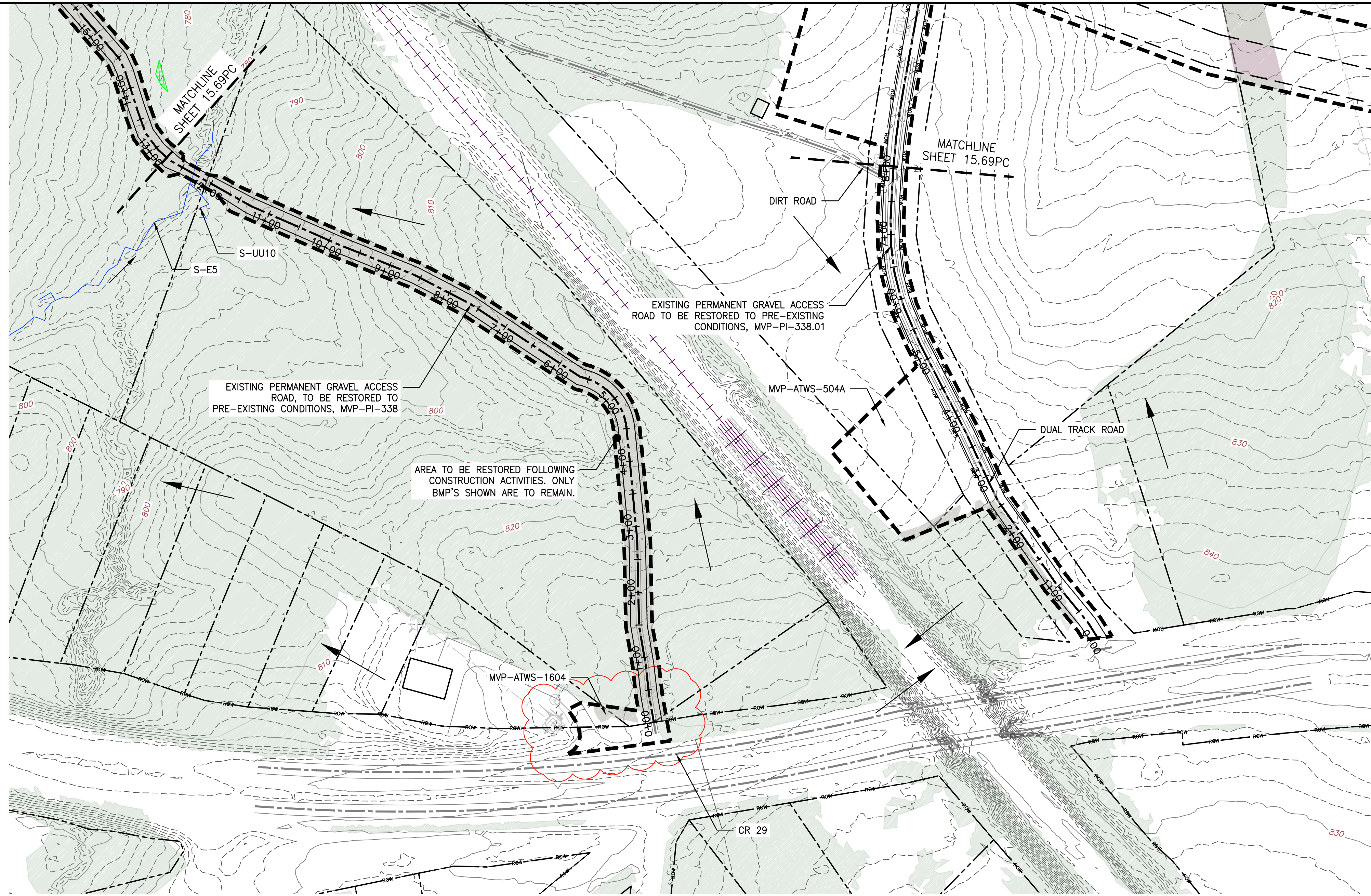
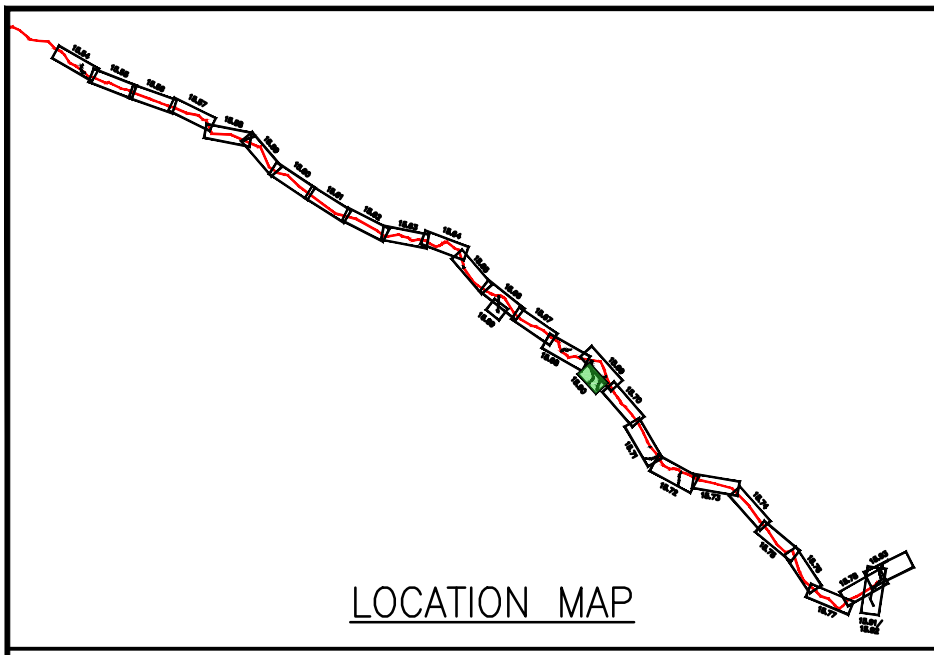

LEGEND

- EXISTING CULVERT
- STREAM
- - - EXISTING PROPERTY LINE
- - - EXISTING STATE LINE
- - - EXISTING COUNTY LINE
- - - EXISTING ROAD/TRAIL
- USDA FOREST SERVICE (NATIONAL FOREST) LANDS
- APPALACHIAN NATIONAL SCENIC TRAIL
- ACID FORMING MATERIAL
- GRASS-LINED CHANNEL (SEE DETAIL MVP-ES39)
- - - PROPOSED LIMIT OF DISTURBANCE
- - - PROPOSED PERMANENT RIGHT OF WAY
- PROPOSED LEVEL SPREADER DIVERSION
- PROPOSED LEVEL SPREADER
- PROPOSED ACCESS ROAD CENTERLINE
- PROPOSED PIPELINE
- SURFACE WATER FLOW DIRECTION
- POND
- WETLAND
- PROPOSED CULVERT WITH OUTLET PROTECTION (SEE DETAILS MVP-ES7, 7.1)
- APPROXIMATE LOCATION OF WATER BAR END TREATMENTS (PENDING FIELD CONDITIONS)
- STREAM FLOW DIRECTION
- FEMA 100 YEAR FLOODPLAIN
- PERMANENT WATER BAR 10' END TREATMENT
- PERMANENT WATER BAR 15' END TREATMENT
- PERMANENT WATER BAR 20' END TREATMENT
- STEEP SLOPE AREA
- EXISTING FOREST
- PERMANENT EASEMENT RESTORED TO MEADOW CONDITION
- TEMPORARY EASEMENT RESTORED TO BRUSH CONDITION

NOTES:

1. NOTE THAT ALL WATER BARS REGARDLESS OF SPECIFIED CALCULATION LENGTH ARE TO BE INSTALLED WITH 20-FT END TREATMENT LENGTHS, EXCEPT AS NOTED IN NOTE 2 BELOW.
2. IN AREAS OF RIDGETOP AS NOTED IN THE TABLE ON THE KEY PLAN OF THIS PLAN SET, WATER BARS WITH END TREATMENT LENGTHS OF 10-FT WILL BE PLACED ON EITHER END.

NO.	DATE	CHKD.	APPD.	DESCRIPTION
7	12/14/18	CAR	DW	FIELD MODIFICATIONS
6	03/21/18	KAL	DW	ADDRESS VADEQ COMMENTS
5	03/16/18	KAL	DW	ADDRESS VADEQ COMMENTS
4	03/04/18	KAL	DW	ADDRESS VADEQ COMMENTS
3	02/20/18	KAL	DW	RESUBMISSION USING APPROVED STORMWATER METHODOLOGY
2	11/21/17	KAL	DW	ADDRESS VADEQ COMMENTS

Mountain Valley Pipeline
POST CONSTRUCTION (STORMWATER & RESTORATION) PLANS
MOUNTAIN VALLEY PIPELINE PROJECT - H600 LINE
 SPREAD 11 - PITTSYLVANIA COUNTY, VIRGINIA
MOUNTAIN VALLEY PIPELINE, LLC
 2200 ENERGY DRIVE
 CANONSBURG, PA 15317

TETRA TECH
 complex world | CLEAR SOLUTIONS™
 661 ANDERSEN DRIVE
 FOSTER PLAZA 7
 PITTSBURGH, PA 15220

**POST CONSTRUCTION
(STORMWATER &
RESTORATION) PLANS**

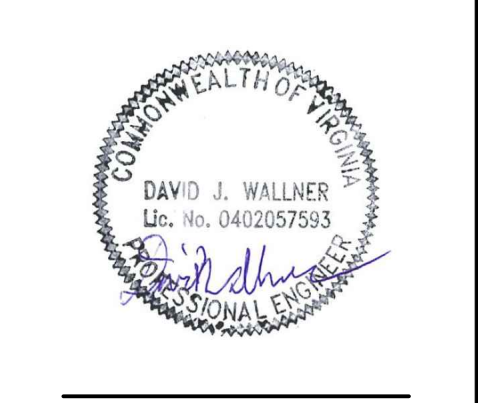

DRAWN BY:	JWK
CHECKED BY:	RE
APPROVED BY:	DW
DATE:	12/14/2018
SCALE:	AS SHOWN
SHT. NO. 15.90PC OF 15.93PC	7 REVISION