

By virtue of this seal and signature, all supporting documents included in this package are accurate and support the design presented herein.

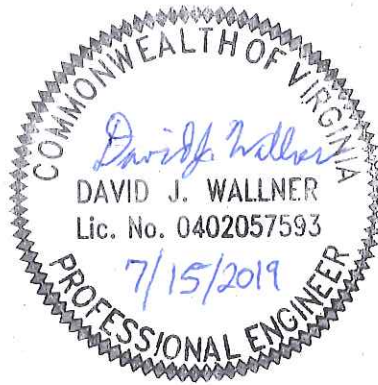

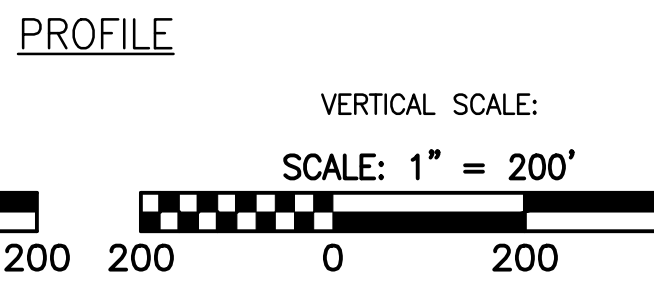

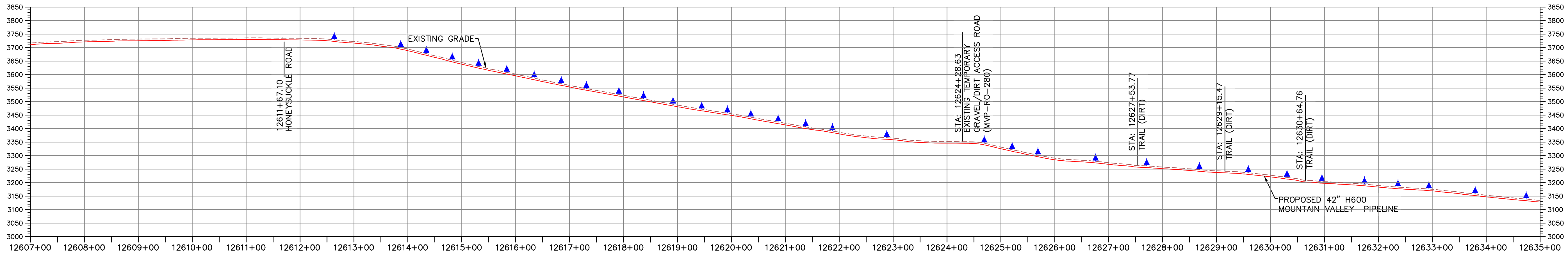
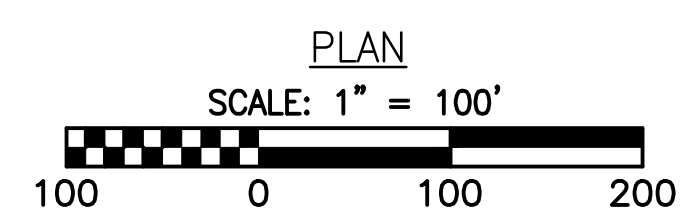
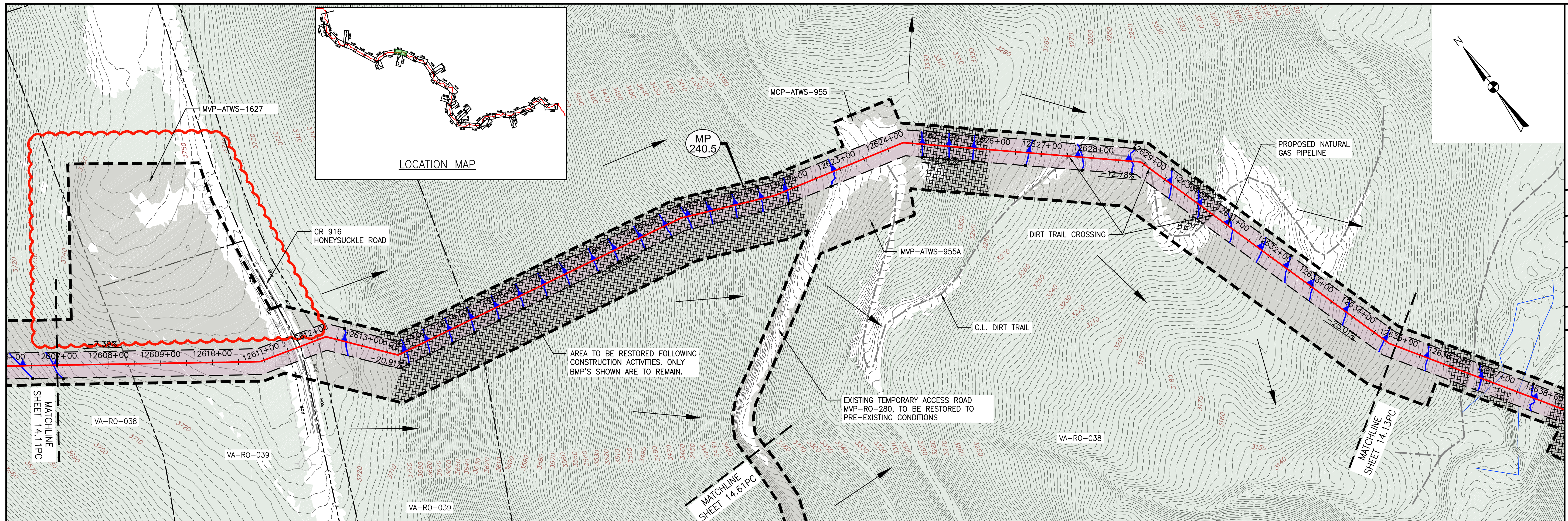

**LEGEND**

—	EXISTING CULVERT	—>>>>	PROPOSED LEVEL SPREADER DIVERSION
—	STREAM	+++++	PROPOSED LEVEL SPREADER
- - -	EXISTING PROPERTY LINE	- - -	PROPOSED ACCESS ROAD CENTERLINE
- - -	EXISTING STATE LINE	- - -	PROPOSED PIPELINE
- - -	EXISTING COUNTY LINE	- - -	SURFACE WATER FLOW DIRECTION
- - -	EXISTING ROAD/TRAIL	▲	POND
—	USDA FOREST SERVICE (NATIONAL FOREST) LANDS	▲	WETLAND
—	APPALACHIAN NATIONAL SCENIC TRAIL	▲	PROPOSED CULVERT WITH OUTLET PROTECTION (SEE DETAILS MVP-ES7, 7.1)
—	ACID FORMING MATERIAL	▲	APPROXIMATE LOCATION OF WATER BAR END TREATMENTS (PENDING FIELD CONDITIONS)
—	GRASS-LINED CHANNEL (SEE DETAIL MVP-ES39)	▲	STREAM FLOW DIRECTION
- - -	PROPOSED LIMIT OF DISTURBANCE	▲	FEMA 100 YEAR FLOODPLAIN
- - -	PROPOSED PERMANENT RIGHT OF WAY	▲	PERMANENT WATER BAR 10' END TREATMENT
		▲	PERMANENT WATER BAR 15' END TREATMENT
		▲	PERMANENT WATER BAR 20' END TREATMENT
		▲	STEEP SLOPE AREA
		▲	EXISTING FOREST
		▲	PERMANENT EASEMENT RESTORED TO MEADOW CONDITION
		▲	TEMPORARY EASEMENT RESTORED TO BRUSH CONDITION

**NOTES:**

- NOTE THAT ALL WATER BARS REGARDLESS OF SPECIFIED CALCULATION LENGTH ARE TO BE INSTALLED WITH 20-FT END TREATMENT LENGTHS, EXCEPT AS NOTED IN NOTE 2 BELOW.
- IN AREAS OF RIDGETOP AS NOTED IN THE TABLE ON THE KEY PLAN OF THIS PLAN SET, WATER BARS WITH END TREATMENT LENGTHS OF 10-FT WILL BE PLACED ON EITHER END.

NO.	DATE	BY	CHKD.	APPD.	DESCRIPTION
1	09/21/17	KAL	RE	DW	PLAN SUBMISSION
2	11/21/17	KAL	RE	DW	ADDRESS VADCO COMMENTS
3	02/05/18	KAL	RE	DW	ADDRESS VADCO COMMENTS
4	02/27/18	KAL	RE	DW	ADDRESS VADCO COMMENTS
5	03/04/18	KAL	RE	DW	ADDRESS VADCO COMMENTS
	05/14/19	JMK	RE	DW	FIELD MODIFICATION - MP 240.1 (MVP-ATWS-1627)

Mountain Valley Pipeline  
**POST CONSTRUCTION (STORMWATER & RESTORATION) PLANS**  
**MOUNTAIN VALLEY PIPELINE PROJECT - H600 LINE**  
 SPREAD 10 - ROANOKE COUNTY, VIRGINIA  
**MOUNTAIN VALLEY PIPELINE, LLC**  
 2200 ENERGY DRIVE  
 CANONSBURG, PA 15311

**TETRA TECH**  
 complex world | CLEAR SOLUTIONS™  
 661 ANDERSEN DRIVE  
 FOSTER PLAZA 7  
 PITTSBURGH, PA 15220

POST CONSTRUCTION (STORMWATER & RESTORATION) PLANS

DAVID J. WALLNER  
 Lic. No. 0402057593  
 PROFESSIONAL ENGINEER

DRAWN BY:	GAR
CHECKED BY:	RE
APPROVED BY:	DW
DATE:	05/14/2019
SCALE:	AS SHOWN
SHT. NO. 14.12PC	OF 14.77PC