



April 10, 2018

Mr. Roger Kirchen
Virginia Department of Historic Resources
Division of Review and Compliance
2801 Kensington Avenue
Richmond, VA 23221

**Subject: Mountain Valley Pipeline Project
Mountain Valley Pipeline Architectural Resource Late Discovery:
VDHR Resource Number 033-5436 (Milepost 268.7)
FERC DOCKET NO. CP16-10, DHR FILE #2014 1194**

Dear Mr. Kirchen:

On behalf of Mountain Valley Pipeline, LLC (Mountain Valley), a joint venture between affiliates of EQT Midstream Partners, LP and NextEra Energy, Inc., Con Edison Midstream Gas, LLC, WGL Holdings, Inc., and RGC Midstream LLC, Tetra Tech, Inc. (Tetra Tech) is providing herein a Phase I National Register of Historic Places (NRHP) evaluation of a historic architectural resource, Virginia Department of Historic Resources (VDHR) No. 033-5436, on Booker T. Washington Highway (Route 122) in Franklin County, Virginia and within the direct Area of Potential Effects (APE) of the Mountain Valley Pipeline Project (MVP) (Figure 1). This resource was recently identified by Tetra Tech archaeologists working in MVP's direct APE after New South Associates had concluded the architectural reconnaissance survey for the project. The barn is located on Access Road MVP-FR-310 that stretches from Booker T. Washington Highway (Route 122) to the MVP pipeline. The road intersects the pipeline at MP 268.7. Architectural resource 033-5436 is located near milepost 268.7.

Architectural resource 033-5436 is not located within a previously recorded rural historic district. Tetra Tech recommends that 033-5436 is not individually eligible for the NRHP nor as a contributing resource to a larger historic resource or historic district. We request your concurrence with this recommendation.

**Barn
3157 Booker T. Washington Highway (Route 122)
Rocky Mount, Franklin County
MP 268.7
VDHR No. 033-5436
Tax ID No. 0450001600**

This barn is located on the north side of Booker T. Washington Highway, east of the curve in the road and west of Gills Creek. A paved driveway off the north side of the road (near MP 268.7) accesses the barn. It is one building in a complex of three that includes a recently constructed house northwest of the barn and a recently constructed pole barn west of the historic barn (Figure 2). The current owners reported the house replaced an older one at or near the same location. The

historic barn was photographed from the public right-of-way. The surveyor did not have access to the other three buildings on the site.

This rectangular, two-part barn has a metal covered roof, vertical board siding and a poured concrete foundation. The barn has two sections, which may have been built at different times: a taller section with a hayloft on the west end and a shorter section on the east end. The two sections connect at the barn's gable ends. An open frame shed projects from the east end of the lower section. The wood frame is visible inside the barn. The interior is configured with a center aisle with stalls and storage areas on either side. The gabled roof is covered in metal sheets over skip sheathing. Vertical plank sliding doors are positioned off center on the west side of the taller section. The north and south sides of the lower section have metal sliding doors (Figures 3-5).

This resource is a circa-1930 barn consisting of two sections with differing roof heights. The barn is not a representative example of any particular building type or technique, and its historic setting has been eroded by the loss of the associated historic dwelling. The resource is not known to be associated with a particular event or person that would make it individually eligible for the NRHP. Therefore, this resource is recommended not eligible for the NRHP under Criterion A, B or C.

Data for 033-5436 has been uploaded into VDHR's data Sharing System for Historic architectural resources and a hard copy survey file will be provided to the VDHR for incorporation into its archive.

Please review this information under Stipulation IV.A. in the executed Programmatic Agreement for the project. This report will also be filed with the Federal Energy Regulatory Commission, lead federal agency for the project. Per Stipulation IV.E., comments should be submitted to Paul Friedman at the FERC. He can be reached at:

Mr. Paul Friedman
Federal Energy Regulatory Commission
888 First Street NE, Room 1A
Washington, DC 20426

(202) 502-8059
Paul.Friedman@ferc.gov

Should you have any questions, feel free to contact Evelyn Tidlow by telephone at (612) 812-5478 or by e-mail at E.Tidlow@gaiconsultants.com. Thank you for your attention.

Sincerely,



Hannah L. Dye, MA
Architectural Historian



Mr. Roger Kirchen
April 10, 2018
Page 3

cc: Megan Neylon, EQT (with no attachments)
Evelyn Tidlow, GAI (with no attachments)





TETRA TECH

**ATTACHMENT 1
FIGURES**

Figure 1. 033-5436 Location Map

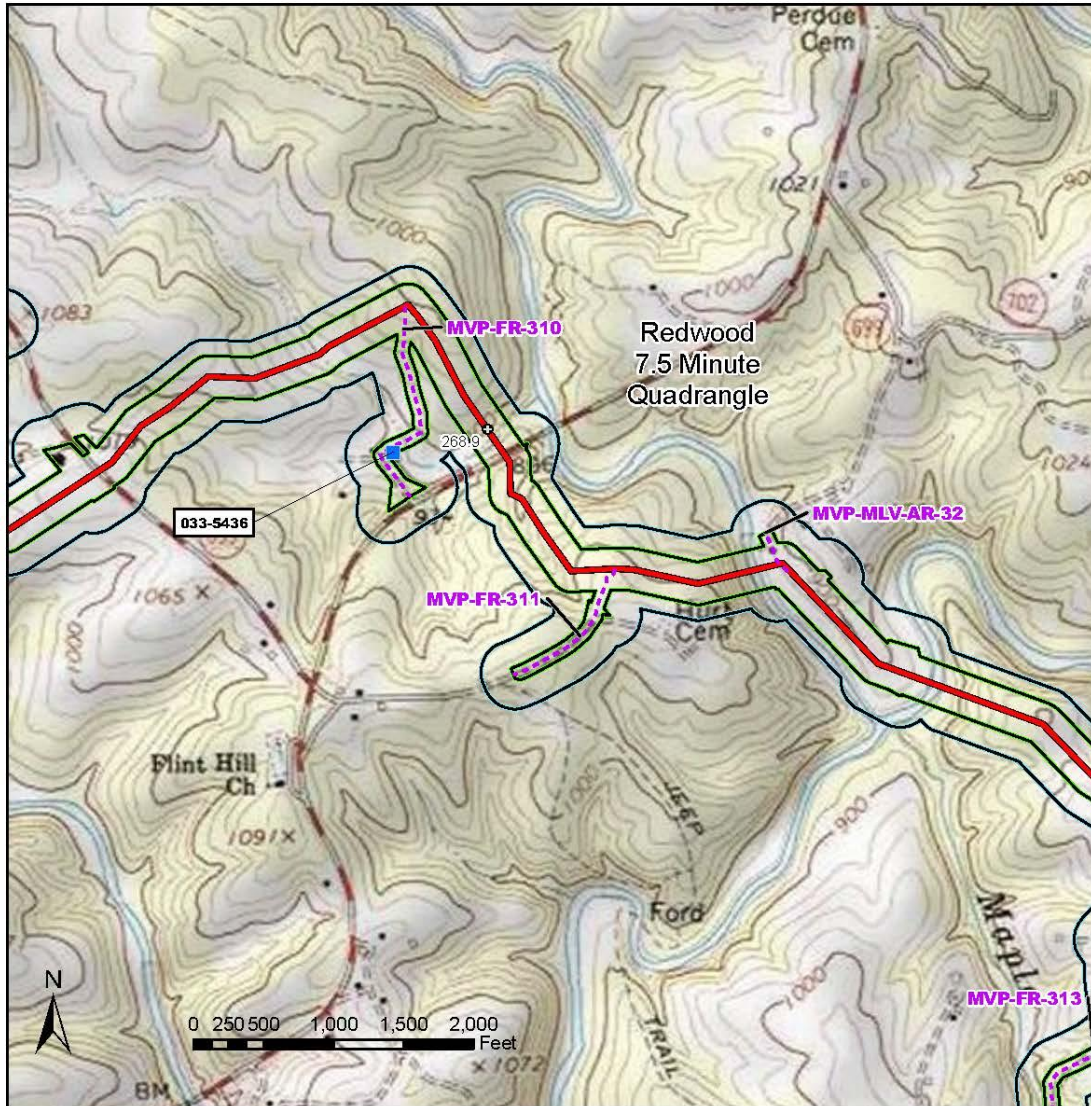

Legend

- Resource Location
- ⊙ Milepost
- - - Proposed Access Road
- Proposed Pipeline
- 300-Foot Direct Effects APE
- Indirect APE for Historic Architectural Resources

Location Map





TETRA TECH

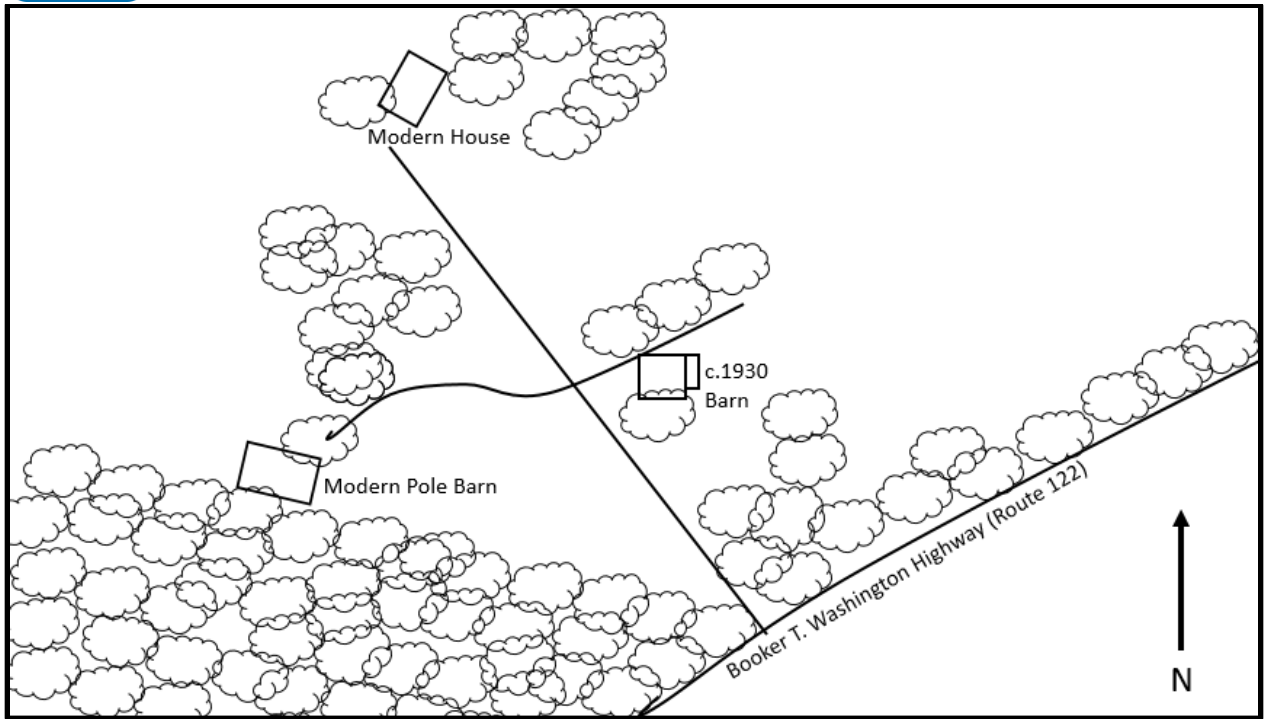

**Figure 2. Site Plan. Barn at 3157 Booker T. Washington Highway (Route 122)
Rocky Mount, Franklin Count**



**Figure 3: Barn at 3157 Booker T. Washington Highway (Route 122)
Rocky Mount, Franklin County, View Northeast**



TETRA TECH



**Figure 4: Barn at 3157 Booker T. Washington Highway (Route 122)
Rocky Mount, Franklin County, View Southeast**



**Figure 5: Barn at 3157 Booker T. Washington Highway (Route 122)
Rocky Mount, Franklin County, View East**